

2011

DASTECC S.R.L.

Representantes / Distribuidores Exclusivos

Buenos Aires, Argentina

Tel.: (54 - 11) 5352-2500

Email: info@dastecsrl.com.ar

Web: www.dastecsrl.com.ar



MUSTANG®

P.O. BOX 490/RT. 68 NORTH

43 RITMORE DR

RAVENSWOOD, WV 26164

P (304) 273-5357

F (304) 273-2531

mustangsampling@valtronicsinc.com

www.mustangsampling.com



[INSTALLATION, MAINTENANCE, & OPERATION MANUAL]

MR & MJTR

Mustang® Regulator & Joule-Thomson Regulators

©2011 Mustang Sampling, LLC

All Rights Reserved

TABLE OF CONTENTS

Safety Warnings	3
Technical Specifications	3
Dimensions	4
Installation Instructions	4
Model Numbering & Additional Part Numbers.....	5



Safety Warnings

- Failure to abide by any of the safety warnings below will result in release of fluid at full pipeline pressure and could result in serious injury or death
 - Do not exceed any equipment pressure ratings.

MR Technical Specifications

Maximum allowable working pressure	3750 psig (259 BAR)
Maximum temperature	300°F (150°C)
Outlet pressure range	0-10, 0-25, 0-50, 0-100, 0-250, or 0-500 *Specify outlet range when ordering
Port sizes	1/4" female NPT
Wetted materials	Machined parts: 316 stainless steel/NACE compliant All other metal parts: stainless steel/NACE compliant Regulator seal material: Teflon® PFA Sealing material: Viton® standard

MJTR Technical Specifications

Maximum allowable working pressure	3750 psig (259 BAR)
Temperature Range	-40°F-400°F (500°F w/ Kalrez) [-40°C-150°C (260°C w/ Kalrez)]
Outlet pressure range	0-10, 0-25, 0-50, 0-100, 0-250, or 0-500 psig (0-0.69, 0-1.72, 0-3.45, 0-6.89, 0-17.24, or 0-34.47 bar) *Specify outlet range when ordering
Port sizes	1/4" female NPT
Wetted materials	Machined parts: 316 stainless steel/NACE compliant All other metal parts: stainless steel/NACE compliant O-ring: Viton®/Kalrez (other materials available upon request)

Dimensions

MUSTANG® REGULATOR

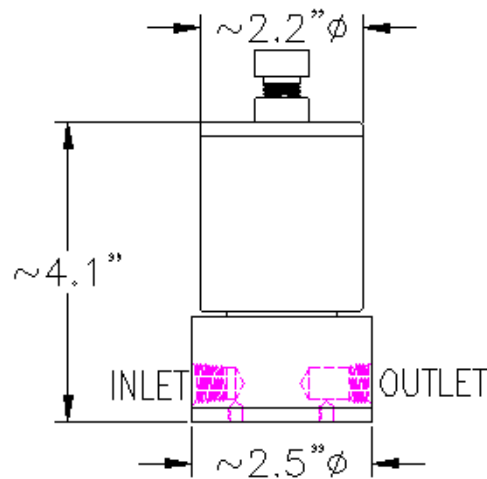

MUSTANG® JOULE-THOMSON REGULATOR

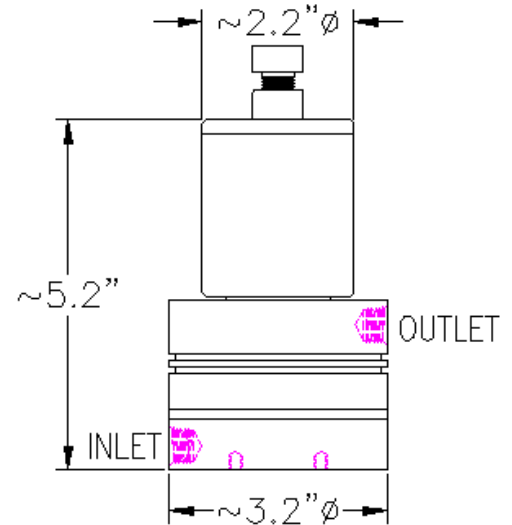

Installation Instructions

- **Step 1. Depressurize the system**
 - Valve off the sample flow prior to installation of the Mustang® Regulator
- **Step 2. Connect the Mustang® Regulator**
 - The Mustang® Regulator inlet and outlet ports are labeled. Connect tubing from the sample stream to the Mustang® Regulator inlet port. Connect tubing from the Mustang® Regulator outlet port to the next device in the sample system.
 - The Mustang® Regulator port that is not labeled is an atmospheric reference port for the regulator. It is threaded so that optional tubing can be connected to this port to enable a “captured vent” if so required; however, this port should NOT be plugged or the performance of the regulator will be affected.
- **Step 3. Adjust Pressure**
 - To allow sample flow, slowly open external valving.
 - At high supply pressure, a sudden change may be observed on the downstream pressure gauge as the valve stem moves away from the seat. Slight re-adjustments may be necessary until the pressure and flow have equilibrated.
 - At this point the sample pressure can be adjusted to the desired value. To raise the outlet pressure, turn the pressure adjustment screw clockwise. To lower the outlet pressure turn the pressure adjustment screw counterclockwise while gas is flowing through the regulator.
 - Tighten the pressure adjustment screw lock nut firmly against the washer to prevent unintended changes in pressure adjustment.

Model Numbering & Additional Part Numbers

Your model number is determined by your specific needs. Choose options below.

⚠ Seat material

0 = Viton®
(other materials available upon request)

Outlet pressure range

0 = 0-25 psig
1 = 0-50 psig
2 = 0-100 psig
3 = 0-250 psig
4 = 0-500 psig
9 = 0-10 psig

How to build the model number:

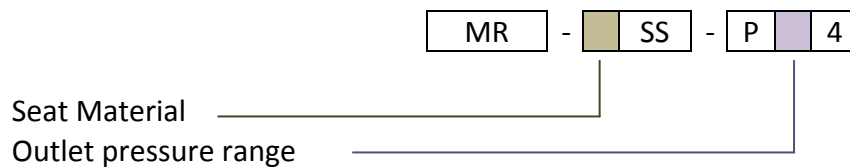

- ⚠ We cannot recommend specific seat materials due to the complex nature of sample stream compositions. Temperature and pressure also may be factors.
- ⚠ Unless specified otherwise, the product will ship with our standard sealing materials and materials of construction stated in the technical specifications section of the corresponding Product Sheet.
- ⚠ Please refer to www.dupontelastomers.com for sealing material recommendations and advice. It is the user's responsibility to specify the sealing materials and other materials of construction for their application.

DASTEC S.R.L.

Representantes / Distribuidores Exclusivos

Buenos Aires, Argentina
Tel.: (54 - 11) 5352-2500
Email: info@dastecsrl.com.ar
Web: www.dastecsrl.com.ar